



MADAME THELMA
CRN

BARNES
YACHTING





MADAME THELMA
CRN

Elegant Majesty: The Ultimate Ocean Explorer

With the yachting season approaching, we proudly present Madame Thelma, a meticulously maintained 39.6-meter classic yacht crafted by CRN in Ancona in 1975. Her welded steel hull, teak-sheathed decks and aluminium superstructure embody Italian excellence and reliability, while extensive refits preserve her timeless elegance. Bureau Veritas class maintenance ensures safety, comfort and enduring appeal for discerning owners worldwide. Her heritage commands admiration among connoisseurs.

Powered by twin Detroit Diesel engines installed in 1994, Madame Thelma cruises effortlessly at twelve knots and reaches a thrilling sixteen knots when desired, with a remarkable range of 3,500 nautical miles for transoceanic adventures. Her thoughtfully reimaged interiors offer generous staterooms, refined lounges, and exquisite mahogany finishes throughout. Advanced navigation, communications and stabilisation systems provide seamless operation and peace of mind on board.

Complementing her classic charm are modern amenities including efficient air-conditioning, substantial water makers, versatile tenders, and comprehensive entertainment systems, ensuring luxury and practicality. Ideal for exploration or leisurely cruising, Madame Thelma harmonises durability, performance and sophisticated technology. She is ready to welcome new owners aboard for unforgettable voyages this summer season ahead.

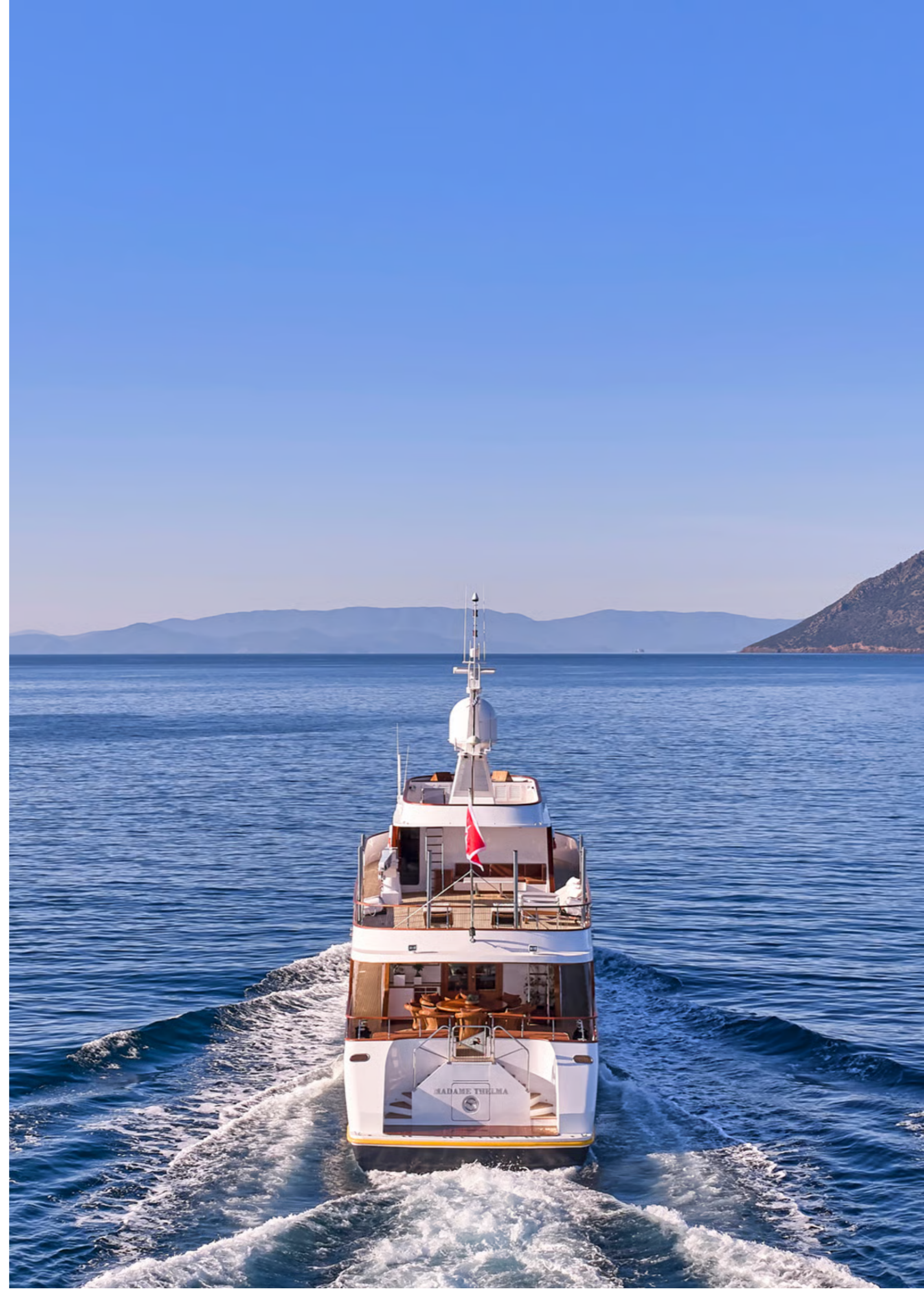





MADAME THELMA CRN

Specifications

Length: 39.6m (129.9')

Beam: 7.52m (24.7')

Draft: 2.85m (9.3')

Flag: Malta

Location: Greece

Year Built/Refit: 1975 / 2024

Builder: CRN

Accommodations: 12 guests in 6 cabins

Crew: Up to 8 crew

Price: €2.850.000

VAT Paid

General Information

Type: Motor -

Construction: Steel Hull and Aluminium Superstructure

Interior Designer: CRN Ancona

Exterior Designer: CRN Ancona

Fuel Capacity: 68.000L / 17.964 US Gal

Water Capacity: 20.000L / 5.283 US Gal

Gross Tonnage: 279 Ton

Engines: 2, Detroit Diesel, GM 12V 149 TIB, 950, Diesel

Cruising Speed: 12 knots

Max Speed: 16 knots

Range: 3.500 nm @ 12 knots

Classification: Bureau Veritas

Description

Accommodation Overview:

Accommodation for 12 guests in 6 staterooms. 8 crew.

Guest Accommodations:

Guest accommodation is located forward on the lower deck and comprises a full-beam VIP suite along with two additional guest cabins. Aft are two further interconnecting guest cabins, offering a particularly versatile configuration that allows them to be used either as a family suite or combined to create a second full-beam VIP cabin with a sitting area. All cabins are en suite and equipped with TVs and quality furnishings throughout.

Deck Spaces:

In addition to inviting interior spaces, MADAME THELMA offers a plethora of 'outdoor facilities, from her expansive upper deck aft to outdoor lounges and sunbathing, connecting guests with the sea at every opportunity.

Main Deck Salon:

Mahogany woodwork throughout with dining area forward sitting 10 people. Lounge area with comfortable sofas and a 55" Sony TV with direct access to the open deck aft.

Owner's Stateroom:

The yacht features a spacious Owner's cabin on the main deck, complete with a private study/office, ensuring comfort and privacy. Finished in rich mahogany throughout, the suite offers elegant detailing and is filled with natural light through large windows

Sun Deck:

A secondary helm station is located on the sundeck, which can also be enjoyed as an...

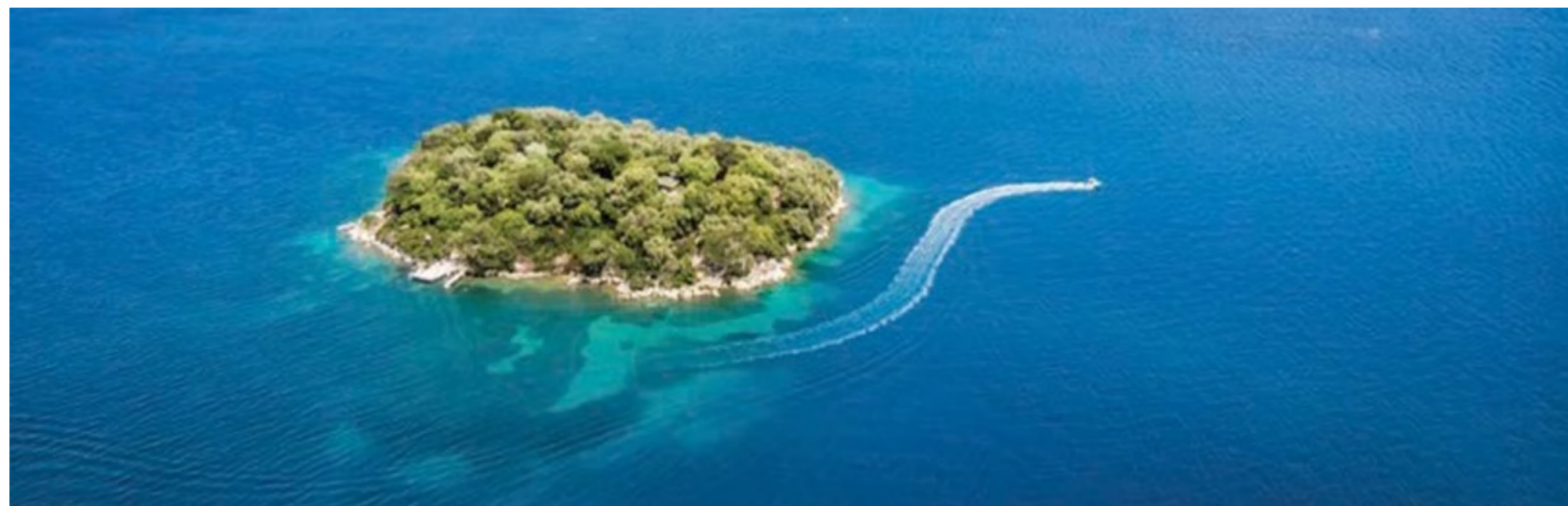

Machinery Details

Main Engines:

2x Detroit Diesel GM 12V 149 TIB 950 Hp (installed 1994)

Engine Hours: Port: 5,265; Stbd: 5,193

Gear Boxes: Reintjes Type DD 540 Rate 7.0-1

Propulsion Type: Conventional shaft drive, Propellers: 2x Solid Screw

Other Machinery:

Bow Thruster: CM 4316T-12D Baldor Electric 75Hp

Stabilizers: Vosper - Koopnautic Control VT H11717 Fin stabilizers

Fuel Oil Separator: Alfa Laval Type MAB 103B24

Fuel Transfer Pump: Garbarino MU32 9.2kw 20 m³/h

Fire Pump: Garbarino 1x MU32 9kw 23 m³/h + 1x MU32 7.5kw 20 m³/h

Bilge Pump: Garbarino MU32 7.5kw 20 m³/h

Ballast Pump: Garbarino IA50 3kw 20 m³/h

Hot Water Boilers: 3x Wilco Titanium Glass

WC's (toilets/bidets): Wisa; Sewage Pump: Garbarino IA70 5.5kW

Hamann: HL - Cont Plus 02 Slim

Fan Coils 11x (main deck salon, master cabin & fwd guest cabins)

Sea Water Pump for Chiller: Calpeda Type BNM4 0.75kW

Fresh Water Pump for Chiller: Hydra Type CRL 80/A

Compressors 2x Condaria

Hot Water Pump for Heating: Hydra Type CRL 50/A

Sea Water Cooling Pump Crew: Calpeda Type BNM4 1.1kW

Fresh Water Circulating Pump Crew: Calpeda Type BNM4 2.2kW

Antifouling System: Type: Chugoku Paints - Seajet 038 Taisho

Generators

2x 80 kW Northern Lights M668TH (installed in 1998)

Gen Hours: Port: 20,831; Stbd: 20,500; Gen Fuel Consumption: 170 lt/day

Gen Exhaust System: Cummins Onan Marine Muffler

Output/Electricity: 220-380V / 50Hz; Shore Power: 380V / 3-ph

Shore Power Transformer: 380V / 220V / 24V

Main Characteristics

Name: MADAME THELMA

Type: DISPLACEMENT MOTOR YACHT

Builder: CRN ANCONA

Year: 1975

Refit Year: 1993 / 1998 / 2024

LOA (M/FT): 39.60 M

LWL (M/FT) 33.40 M

Length CoR: 35.47 M

Beam moulded (M/FT): 7.52 M

Draft (Full Load) (M/FT): 2.85 M

Gross Tonnage: 279

Displacement: 210

Hull Material: Steel

Superstructure: Aluminum

Decks: Teak

Flag: MALTA

Classification: Bureau Veritas

Naval Architect: CRN Ancona

Exterior Designer: CRN Ancona

Interior Designer: CRN Ancona

Main Engines: 2 x Detroit Diesel GM 149 TIB 12V (installed 1994)

Max Speed: 16

Cruising Speed: 12

Range: Approx 3500 n. miles

Guest Accommodations: 12

Crew Accommodations: 8

Classification

Flag: MALTA

Port of Registry: VALETTA

Classification: Member of IACS

IACS Society: BUREAU VERITAS

Additional Class Information: I ± HULL ± MACH Yacht – motor - S

EU VAT Status: PAID

MMSI Number: 215620000

Official Registration: 08724

Home Port: MARINA ZEA, GREECE

Regulation

Vessel Registration: PRIVATE

Construction

Hull Material: Steel

Superstructure Material: Aluminum

Decks Material: Teak

Paint: White

Motor Hull Type: Displacement

Number of Decks: 3

Capacities

Gross Tonnage: 279; Net Tonnage: 83; Displacement Tons: 210

Fuel Capacity: 68,000 Litres ; Fresh Water Capacity: 20,000 Litres

Water Makers: 2 x Idromar MC 105 420 Litres/h

Black & Grey Water: 10,000 Litres ; Lube Oil: 2,000 Litres

	Speed	L/h	Range	RPM
Maximum:	15	400		1800
Cruising:	12	270	3,500	1350

Communication & Navigation

Communication Systems

SAT WiFi: Starlink

VHF Radiotelephones: Furuno FM – 8500 + Icom IC-M126 DSC + Simrad RS12 (Sun Deck)

Portable VHF: Icom ICM23 x2

Telephone System: Ericsson

EPRIB: Jotron Tron 60 AIS

Radar Transponders: Jotron Tron SART 20

Navtex Receiver: Furuno NX-500

Internal Ship's Communication: Telephones

Navigation Systems

Radar: Furuno FR-1510

Multifunctional Workstation: 2 x Raymarine Axiom 2 Pro 16 S MFD

Magnetic Compass: Yes

Gyrocompass: Furuno Satellite Compass

Auto Pilot: Raymarine

Echo Sounder Furuno FCV 292; Speed Log Autohelm

GPS: Furuno GP 33; AIS: Jotron Tron 60

Wind Instruments: Autohelm

Horn: Yes; Search Lights: x2

Safety, Firefighting & Security

CCTV HIK VISION (Upper Deck / Engine Room / Deck Monitoring)

Cameras: 4x Engine room & Upper deck aft

Monitors: Bridge & Crew Mess

Fixed Firefighting System: CO2 engine room firefighting system

Firefighting Equipment: 38 x Fire Extinguishers

Fire Alarm: Smartline Notifier AFP-200 with Smoke Detectors

Alarms: Bilge - Sanitary tank

MOB boat:

Life rafts: 2 x 12 persons Pack B

Deck Equipment

Anchors: 2x 210kg

Anchor Chains: 2x 16mm 150m

Anchor Windlass System: 2x Ercole 3614F 3500W

Tender Crane: Electric

Warping Capstans Stern: 2x Macheric 112 5.5hp

Passerelle: 1 x Biotecnomare

Side Boarding Ladder: Yes

Spotlights: YES - bow and stern

Tenders & Toys

Tenders: 1 x ZODIAC 470 - Yamaha outboard engine 60 Hp

Entertainment Equipment

Main Salon: Sony Bravia 55" TV

Master Stateroom: Sony Bravia 55" TV

VIP Stateroom: Sony Bravia 55" TV, Alpine Car Audio

Guest Stateroom Aft: Samsung TV 32", Alpine Car Audio

Sky Lounge: Fridge Morris in Pantry area

Crew Mess: F&U 32" TV

Galley & Laundry Equipment

Main Galley Equipment

Cooking Equipment: Angelopo cook hob (Oven and 6 Burners)
2x Gaggenau Grill

Deep Fryer Galore

Refrigeration/Freezer: Foster Fridge + Freezer + 1x Bauknecht Fridge

Dishwasher: Princess

Other: 1 x Toyotomi microwave

Pantries And Others

Refrigeration/Freezer: Whirlpool

Icemaker

Other: 2x Nespresso machines + Coffee machine

Crew Galley / Mess Equipment / Cooking Equipment

Microwave: Candy

Refrigeration/Freezer: 2x Fridges + 1x Bosch Fridge w/Freezer

Other: Candy Electric Stove with oven and 4x Burners

Nespresso machine + Philips Coffee machine

Laundry Equipment: Bosch Washing Machine - Haier Drying Machine

Capital Improvements

2024

Full yacht repaint, hull & superstructure (Awlgrip)

New teak deck and wooden side rails

Major service in all hydraulic equipment incl. crane, passerele, fin stabilizers

BV Class surveys completed including dry-docking

1998

Stern recesión & refit in CRN with a new swimming platform and stairs access

New 2x NorthernLights 80kw generators installed and commissioned

1994

New Main Engines installed and commissioned

New A/C & Hot air system for guest areas installed

























**Vessel
Details**

Guide Price: €2.850.000
Length: 39.6m (129.9')

Built/Refit: 1975 / 2024
Lying: Greece

Crew: Up to 8
Flag: Malta

Disclaimer: These particulars have been prepared by Barnes Yachting from information provided by the sellers and are intended as a general guide to the vessel. Barnes Yachting cannot, however, be liable for any inaccuracy. It is up to the purchaser to confirm details of concern to him by survey, inspection and/or enquiry of the seller and to ensure that the purchase contract properly reflects his concern and specific details upon which he may rely. Barnes Yachting will always advise an independent survey.

UPPER DECK

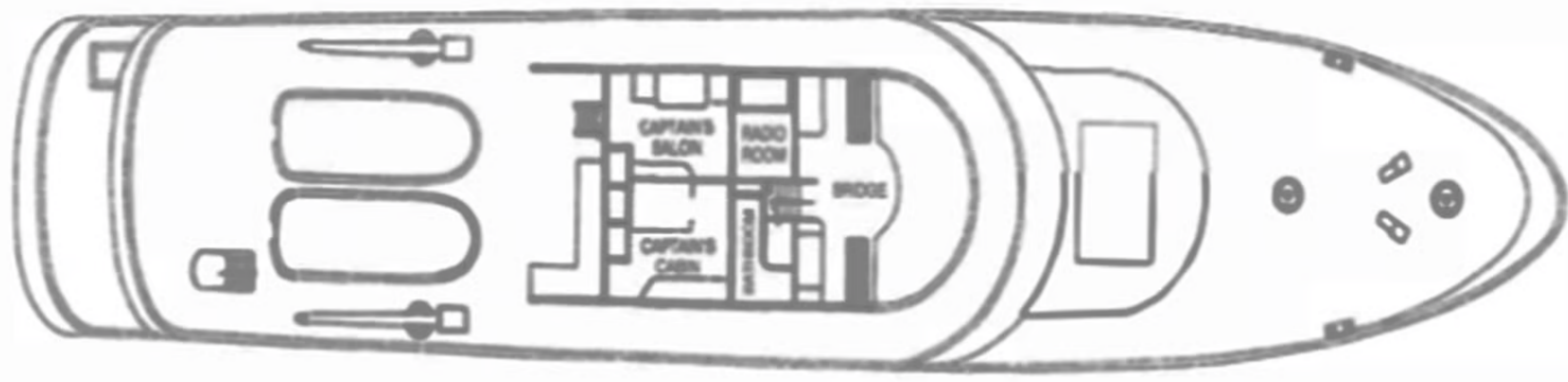

MAIN DECK

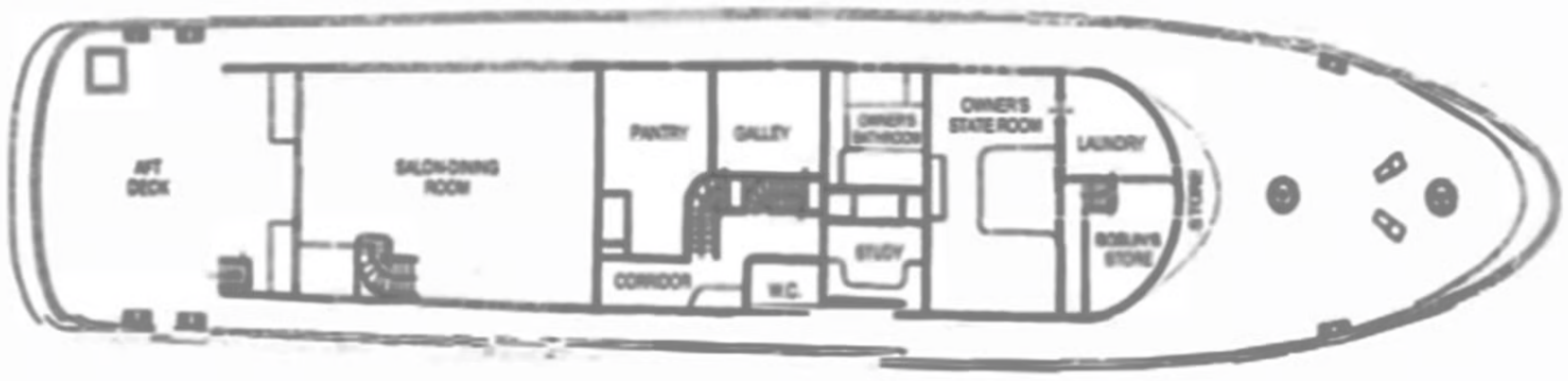

LOWER DECK



BARNES
YACHTING



BARNES YACHTING

+34 634 81 37 95

Europe +44 20 4587 8777 / / USA +1 305 525 9301

yachting@barnes-international.com

www.barnes-yachting.com

