



SEMPER FIDELIS
Fontaine Pajot

BARNES
YACHTING



Alegria 67

FONTAINE PAJOT



SEMPER FIDELIS
Fontaine Pajot

Semper Fidelis · Catamaran of Distinction

The Fontaine Pajot Alegria 67, delivered in 2022, embodies a refined balance between performance and comfort. With her expansive beam and carefully engineered hulls, she offers remarkable stability at sea while maintaining sleek, modern lines that capture attention in every harbor. Her fiberglass construction ensures durability and efficiency, while her sail plan and twin Volvo engines provide versatility for both cruising and performance sailing.

On deck, the Alegria 67 is designed for social living and effortless navigation. Expansive lounging areas, a flybridge with commanding views, and a hydraulic platform for tender handling create a seamless connection between relaxation and practicality. Every detail has been considered to enhance life on board, from synthetic teak finishes to integrated entertainment systems.

Inside, the yacht offers a sophisticated layout with generous accommodations for guests and crew. Natural light floods the saloon and cabins, while premium materials and thoughtful design elevate the onboard experience. With advanced systems, ample storage, and luxurious amenities, this catamaran.





BARNES
YACHTING





SEMPER FIDELIS

Fontaine Pajot

Specifications

Length: 20.36m (66.8')

Beam: 9.84m (32.3')

Draft: 1.7m (5.6')

Flag: Malta

Location: BVI

Year Built: 2022

Builder: Fontaine Pajot

Accommodations: 8 guests in 4 cabins

Crew: Up to 2

Price: \$2.799.000

General Information

Type: Sail

Construction: Composite GRP Hull and Superstructure

Interior Designer: Berret Racoupeau Yacht Design

Exterior Designer: Berret Racoupeau Yacht Design

Fuel Capacity: 1.200L / 317 US Gal

Water Capacity: 1.150L / 304 US Gal

Gross Tonnage: 35 Ton

Engines: 2, Volvo Penta, Volvo D3, 150, Diesel

Cruising Speed: 10 knots

Max Speed: 17 knots

Range: -

Classification: -

Description

Accommodation Overview:

Accommodation for 8 guests in 4 staterooms. 2 crew.

Owner

The master suite is designed as a private retreat, offering a spacious cabin with abundant natural light, refined finishes, and direct access to onboard amenities. It combines comfort and privacy, ensuring a serene environment for extended stays at sea.

Guests

Five guest cabins provide generous accommodations, each with en-suite facilities and thoughtful storage solutions. The layout emphasizes both comfort and functionality, with natural ventilation, courtesy lighting, and elegant furnishings that create a welcoming atmosphere for family and friends.

Crew

Two dedicated crew cabins ensure professional service and operational efficiency. Each cabin is equipped with essential amenities, allowing crew members to maintain comfort and readiness. Their placement ensures privacy for guests while supporting seamless yacht operations.



Machinery Details

Main Engines:

2 × Volvo D4 (150 hp, 3,900 hours)
Shaft drive with 3-blade bronze props

Other Machinery:

Bow thruster: Yes
Steering: Hydraulic system
Fuel filters: Standard Volvo system
Water systems: Fresh water pump, watermaker 220 L/h
Hot water: Electric boiler
Air conditioning: Full tropicalized system

Generators

2x Fisher Panda 12 kW
Electricity: 220V, 50Hz, single phase
Shore Power: Equipped
Batteries: AGM 24V - 150Ah additional units (supply & exhaust)

Communication & Navigation

VHF Antenna 1x Mast head antenna prewired

Radar 1x Garmin system

Black Box Sonar 1x Garmin GSD26 + Airmar sensor R109LHW

Navigation Pack 4x Garmin Pack

Security, Fire Fighting & Safety

Mooring Kit 1x Complete set + 6 fenders

Anchor 1x Rocna 70 kg

Chain 1x 100m, 14 mm

Liferaft 2x MP8 container type

Fog Horn 1x Dual control stations

Deck Equipment

Windlass 1x Electric 2000 W

Winch 1x Electric for main halyard

Winches 2x Genoa electric winches

Winch 1x Main sheet electric winch

Capstans 2x Cockpit mounted

Rope Cutters 2x

Tenderlift Platform 1x Hydraulic, 450 kg max

Sun Awning 1x Cockpit

Tent 1x Cockpit

Fridge 1x Cockpit 65 L

Fridge 1x Flybridge 65 L

Synthetic Teak

Bimini 1x Fixed flydeck type

Mast Lighting 1x

Underwater Lights 2x 50 W

Sails and Rig

Mainsail

1x CST mainsail, full batten configuration

1x Lazy jack system

1x Lazy bag system

1x Dralon protective cover for wheel

1x Canoe boom with lazy bag

Headsails

1x Genoa sail, 1040 ft² / 100 m²

1x Genoa electrical furler

2x Genoa electric winches

1x Staysail on electric furler

Rigging & Deck Hardware

1x Electrical winch for main halyard

1x Main sheet electric winch

1x Mast lighting system

1x Mast and boom painted white

Sail Area

Total sail area: 1400 ft² / 130 m²

Tender & Toys

Tender 1x Highfield 4.2 m + Honda 50 HP engine

Dinghy Brackets 1x Removable set

Entertainment Equipment

TV 1x 46" Audio & Video Pack

HiFi 1x Flying bridge system + 4 speakers

TV System 1x PAL & SECAM

Domestic Equipment

Microwave Oven 1x 220V

Dishwasher 1x

Washing Machine 1x 5 Kg, 220V

Dryer 1x 220V

Sink Grinder 1x

Icemaker 1x Cockpit mounted

BARNES
YACHTING





BARNES
YACHTING



















Heading Hold
210 225 240 255

235

3.52 2411
3.19
141 251
8.4

Home
GARMIN

Waypoints
Standby

BARNES
YACHTING





**Vessel
Details**

Guide Price: \$2.799.000
Length: 20.36m (66.8')

Built in: 2022
Lying: BVI

Crew: Up to 2
Flag: Malta

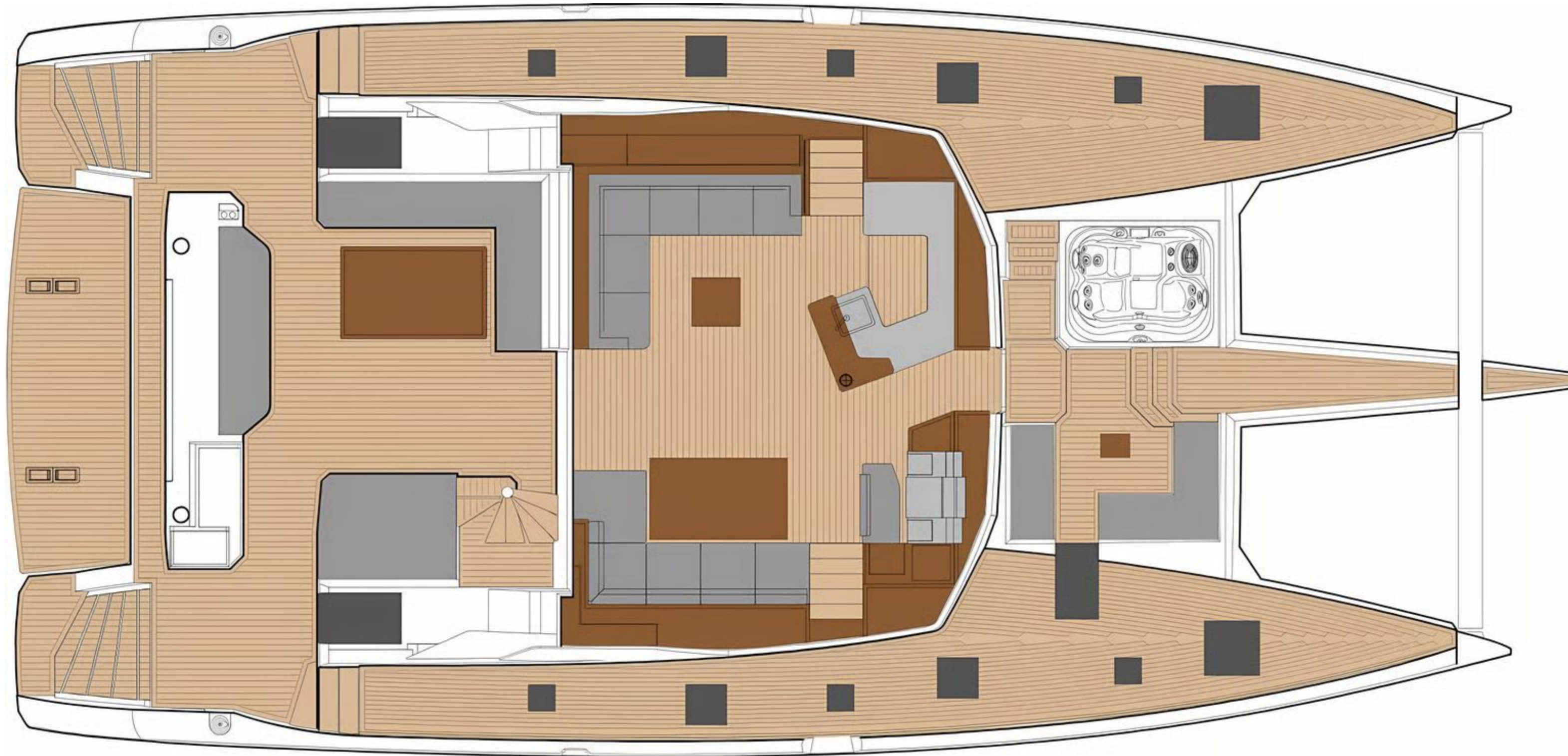

Disclaimer: These particulars have been prepared by Barnes Yachting from information provided by the sellers and are intended as a general guide to the vessel. Barnes Yachting cannot, however, be liable for any inaccuracy. It is up to the purchaser to confirm details of concern to him by survey, inspection and/or enquiry of the seller and to ensure that the purchase contract properly reflects his concern and specific details upon which he may rely. Barnes Yachting will always advise an independent survey.

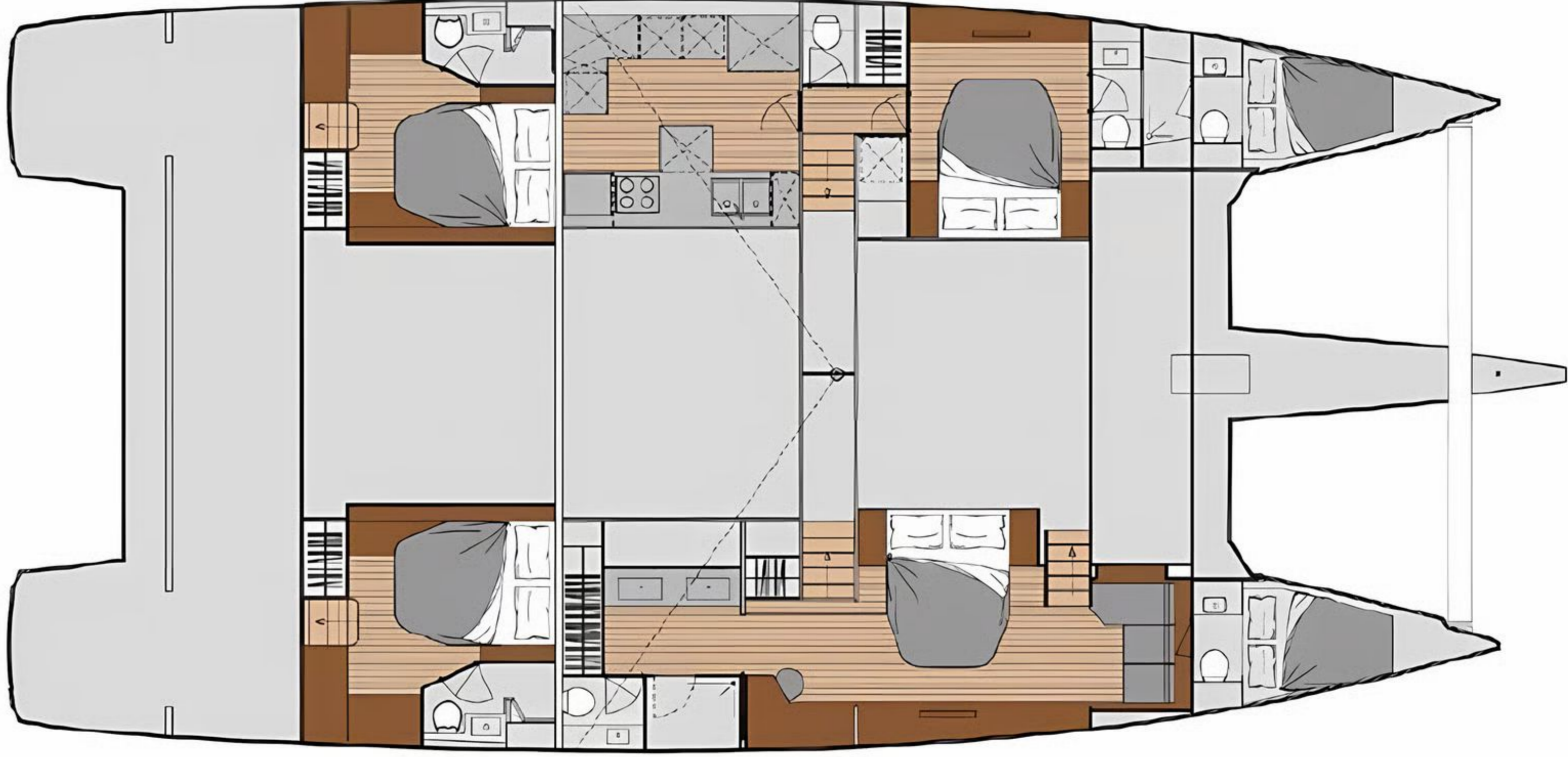

BARNES
YACHTING



BARNES YACHTING

+34 634 81 37 95

Europe +44 20 4587 8777 / / USA +1 305 525 9301

yachting@barnes-international.com

www.barnes-yachting.com

